



Affordable
Architecturally Designed
Tiny Homes, Cabins and Transportables



The Smart Way to Live & Enjoy Life

Quality homes that are both architecturally designed and affordable. Movapod's are handcrafted with you in mind, with sizes for every purpose so you can enjoy as a bach with friends and family, as an office or as a second dwelling to generate extra income.



New Zealand Made



Council Code of Compliance



Fixed Price Guarantee



NZ Wide Delivery

Why you'll love Movapod

We design and manufacture our pods here in New Zealand from the ground up, by a team of dedicated professionals. Our team keeps everything simple and hassle-free for you, from our first contact to the delivery of your pod.

NZ Designed and Built

Our pods are crafted with care and quality needed to stand the test of time.

Designed and built to NZ code by licensed builders, plumbers and electrician's. All pods with a kitchen and bathroom come with a Council Code of Compliance Certificate.

- Architecturally designed
- Built to NZ building code by licensed builders
- Council Code of Compliance Certificate

Stylish and Customisable

Get a great looking architecturally designed pod that is customised to your style, by choosing:

- Pitched or flat roof
- Can be connected to a wooden pile foundation, screw piles or built on a trailer
- Kitchen colours
- Exterior and interior colours
- Comes ready to be connected to drainage and power, or an off grid kit is available.
- Modular, our pods can be connected together

Kingfisher

From **\$149,000***
Including GST. Excluding Delivery

 **1 Bed**  **1 Bath**  **1 Kitchen**  **24m² | 8m x 3m**



Council Code of Compliance Certificate (CoC)
Electrical & gas certificates

Kingfisher is our smallest but comfortable, single story, tiny home.

It features a large bedroom with a generous amount of window for amazing views, an ensuite, and a spacious open plan kitchen-living area.

Creating a convenient fully self contained space.

As standard it's built on skids which can be connected to pile foundations and plumbed into the ground, or as an upgrade can be built on a trailer.



* All prices include GST and are ex Movapod Factory. Prices are subject to adjustment. Price includes building consent for manufacturing. Excludes delivery, foundations, site works and resource consent if required.

Features and Specifications

Materials

- Coloursteel Roof
- Timber framing
- Cladding: Weathertex or Coloursteel
- Plywood interior walls and ceiling
- Double glazed Aluminium windows
- Wooden bearers and joists
- Wall, ceiling and underfloor insulation

Kitchen

- Separate living
- Kitchen
- Kitchen Island Bench (optional extra)
- Built-in oven
- 4 Gas hobs
- Integrated Rangehood
- Dishwasher (optional extra)

Bathroom

- Shower 900 x 900
- Toilet, bathroom vanity, extractor fan, heater, towel holder & toilet roll holder

Furnishings

- Full-length curtains on ranch slider & bedroom

Electrical & gas

- Either electric or gas HW (gas califont included)
- Heat pump (optional extra)
- 32 amp power supply
- TV outlet & Fibre Hub
- LED downlights
- Smoke alarm

Flooring

- Carpet, underlay & vinyl flooring

Storage

- Optional wardrobes in bedroom



Mono or Pitched Roof



Artists impression of the Kingfisher.

Kaka

From **\$159,000***
Including GST. Excluding Delivery

 **1 Bed**  **1 Bath**  **1 Kitchen**  **30m2 | 10m x 3m**



Council Code of Compliance Certificate (CoC)
Electrical & gas certificates

Kaka is our most popular home.

It features a larger kitchen with an island bench, a double size bedroom with a generous amount of window for amazing views and an ensuite. Perfect to rent out as a one bedroom unit.

As standard it's built on skids which can be connected to pile foundations and plumbed into the ground, or as an upgrade can be built on a trailer.

* All prices include GST and are ex Movapod Factory. Prices are subject to adjustment. Price includes building consent for manufacturing. Excludes delivery, foundations, site works and resource consent if required.



Features and Specifications

Materials	Coloursteel Roof Timber framing Cladding: Weathertex or Coloursteel Plywood interior walls and ceiling Double glazed Aluminium windows Wooden bearers and joists Wall, ceiling and underfloor insulation
Kitchen	Separate living Kitchen Kitchen Island Bench (optional extra) Built-in oven 4 Gas hobs Integrated Rangehood Dishwasher (optional extra)
Bathroom	Shower 900 x 900 Toilet, bathroom vanity, extractor fan, heater, towel holder & toilet roll holder
Furnishings	Full-length curtains on ranch slider & bedroom
Electrical & gas	Either electric or gas HW (gas califont included) Heat pump (optional extra) 32 amp power supply TV outlet & Fibre Hub LED downlights Smoke alarm
Flooring	Carpet, underlay & vinyl flooring
Storage	Optional wardrobes in bedroom

Kaka Layout Options

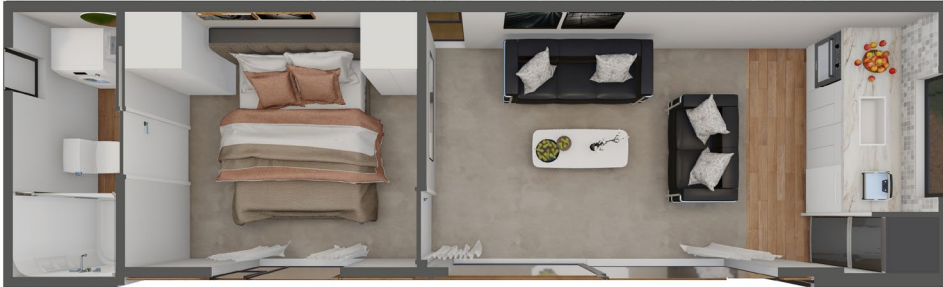

Kaka | End Kitchen

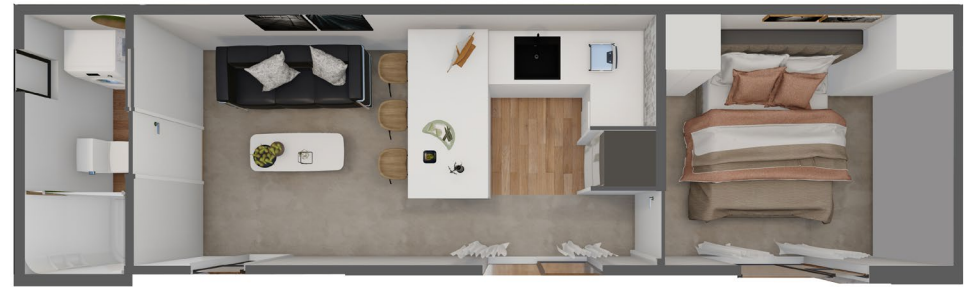

Kaka | Centre Kitchen



Kaka | End Kitchen Island Bench



Kaka | Centre Kitchen, End Lounge



Kaka | Centre Bathroom



Want Something Different?

We're specialists in transportable buildings, tiny homes and cabins. We can customise our plans to your needs.

Pukeko

From **\$199,000***
Including GST. Excluding Delivery

 **2 Bed**  **1 Bath**  **1 Kitchen**  **50m2 | 12m x 4.3m**



Council Code of Compliance Certificate (CoC)
Electrical & gas certificates

Pukeko is our bigger home. It features two or three bedrooms, a bigger bathroom with a 1400 x 900 shower, a spacious open plan kitchen-living area with huge windows to soak in the amazing views.

As standard it's built on skids which can be connected to pile foundations and plumbed into the ground. All of our pods are customisable and modular, they can be connected together to create a larger home.

* All prices include GST and are ex Movapod Factory. Prices are subject to adjustment. Price includes building consent for manufacturing. Excludes delivery, foundations, site works and resource consent if required.



Features and Specifications

Materials	Coloursteel Roof Timber framing Cladding: Weathertex or Coloursteel Plywood interior walls and ceiling Double glazed Aluminium windows Wooden bearers and joists Wall, ceiling and underfloor insulation
Kitchen	Separate living Kitchen Kitchen Island Bench (optional extra) Built-in oven 4 Gas hobs Integrated Rangehood Dishwasher (optional extra)
Bathroom	Shower 1400 x 900 Toilet, bathroom vanity, extractor fan, heater, towel holder & toilet roll holder
Furnishings	Full-length curtains on ranch slider & bedroom
Electrical & gas	Either electric or gas HW (gas califont included) Heat pump (optional extra) 32 amp power supply TV outlet & Fibre Hub LED downlights Smoke alarm
Flooring	Carpet, underlay & vinyl flooring
Storage	Optional wardrobes in bedroom

Pukeko Layout Options



Pukeko | One Bedroom



Pukeko | Three Bedroom, Separate Laundry



Pukeko | Two Bedroom, Centre Bathroom



Pukeko | Three Bedroom



Pukeko | Two Bedroom, Centre Kitchen



Want Something Different?

We're specialists in transportable buildings, tiny homes and cabins. We can customise our plans to your needs.



Models and Pricing

	Beds	Size	M2	Roof Pitch	Cladding	Price from Incl GST
Kingfisher	1 Bed, 1 Bath, 1 Kitchen	8 x 3	24m2	Gable or Mono	Colour steel or weathertex	\$149,000*
Kaka	1 Bed, 1 Bath, 1 Kitchen	10 x 3	30m2	Gable or Mono	Colour steel or weathertex	\$159,000*
Pukeko	2 Bed, 1 Bath, 1 Kitchen	12 x 4.3	50m2	Gable or Mono	Colour steel or weathertex	\$199,000*

* All prices include GST and are ex Movapod Factory. Prices are subject to adjustment. Price includes building consent for manufacturing. Excludes delivery, foundations, site works and resource consent if required.



You could get up to 15.5% rental return.

Based on the Kaka Standard at \$400pw.



Want Something Different?

We're specialists in transportable buildings, tiny homes and cabins. We can customise our plans to your needs.

Our Process is Faster and Cost Effective

A prefab home can be built more cost effectively and faster than traditional homes and we are here to help you every step of your journey.

1. Select & Specify

We can help you choose the right size and model to suit your needs, specify the layout and features, and we'll send you a quote.

- Consultation and preliminary design
- Contract offer and acceptance
- 50% deposit paid

2. Build

With innovative construction techniques we combine the best materials with the best furnishings to create tiny homes of exceptional quality and affordability.

- Site visit
- Detailed design, planning and consents
- Construction
- 25% progress payment paid

3. Delivery

Approximately 8-12 weeks from order confirmation, your new Movapod home will arrive by truck, with you dealing directly with our team throughout the whole process.

- Delivery
- Move in!
- Final 25% payment paid



Great finance options

Using our finance partners is the easiest way to make your tiny house dream come true. Whether it's financing for pods fixed to the ground or lending for Transportable Homes.



Artists impression of the Pukeko.

PO Box 31036
Christchurch
New Zealand
021 220 8521
hello@movapod.co.nz

www.movapod.co.nz



movapod

Affordable, Architecturally Designed
Tiny Homes, Cabins and Transportables